

Material No:	<u>111-7891</u>	Rev:	A	Release/Change Authorization Number:	5095416	CONFIDENTIAL
Description:	MANUAL OP SPIRIT 41 AD RR [617_619:EN]			Issue Date :	10/14/2014	
HAYTER Technical Publications Assembly				Supersedes:		
				Created By :	LH	
				Scale :	None	
	THIS UNPUBLISHED DOCUMENT CONTAINS HAYTER CONFIDENTIAL AND PROPRIETARY INFORMATION. IT MAY NOT BE WHOLLY OR PARTIALLY COPIED, DISCLOSED TO OTHERS, OR USED FOR ANY PURPOSE WITHOUT WRITTEN PERMISSION FROM HAYTER. IF PUBLICATION OCCURS, THE FOLLOWING NOTICE APPLIES: "HAYTER ALL RIGHTS RESERVED".					
Reason for Revision:	RELEASE TO PRODUCTION					

Comments

COVER PAGE FOR MANUAL OP SPIRIT 41 AD RR [617_619:EN]



HAYTER
MAKERS OF THE FINEST MOWERS

Spirit 41 Push and Autodrive
Codes 617J & 619J

OWNER'S HANDBOOK



Original Version (EN)
Issued: 14/10/2014

From Serial Number: 31500001 Onwards
Part number: 111-7891 Rev A

CONTENTS

Introduction	3	Grassbag	10
Safety Compliance	3	Collection Without Grassbag	10
Main Features	4	Heavy Growth	11
Specifications	4	Friction Disc	11
Safety Symbols	5	Non Grassed Areas	11
Safety Precautions	6 - 7	Maintenance Schedule	12
Safety Alert Symbol	6	Mower Maintenance	13 - 15
Training	6	Engine Detail	13
Preparation	6	Carburettor Adjustments	13
Operation	6 - 7	Oil Service	13
Maintenance & Storage	7	Air Cleaner Service	13
Assembling the Mower Before First Use	8	Spark Plug Service	13
Delivery Checklist	8	Keeping Engine Clean	14
Handlebar	8	Grassbag	14
Grassbag Assembly	8	Deck Housing	14
Grassbag Attachment	8	Securing Nuts & Bolts	14
Prevent Engine Damage	8	Clutch Cable Adjustment	14
Oil Type	8	Lubrication	14
Check Oil Level	8	Cutterblade Removal	14 - 15
Operating the Mower	9 - 11	Cutterblade Assembly	15
Fuel Type	9	Cutterblade Sharpening	15
Controls	9	Storage	15
Starting	9	Lawn Care Calendar	16
Forward Travel	9	Trouble Shooting	17
Reverse Travel	9	Warranty	18
Turning	10	EU Privacy Statement	19
Stopping	10	Notes	19
Slopes	10	Service Records & Customer Information	20
Height of Cut	10		
Before Mowing	10		

INTRODUCTION

Thank you for purchasing a Hayter mower. The following pages are designed to help you gain safe and efficient service from your machine.

IMPORTANT: This 'Owners Handbook' should be regarded as part of the mower as it gives essential information regarding mower safety, operation, maintenance and specifications. Read and understand this handbook prior to operating your mower for the first time. Make sure you are familiar with all the controls and points of regular maintenance. If you have any doubts, consult your local Hayter authorised dealer who will be pleased to give you assistance.

IMPORTANT: This mower is designed solely for use in a domestic grass cutting environment. Use in any other way is considered as contrary to the intended use. Compliance with and strict adherence to the conditions of operation, service and repair as specified in this handbook also constitute essential elements of the intended use.

This mower should be operated, serviced and repaired only by persons who are familiar with its particular characteristics and who are acquainted with the relevant safety procedures.

The safety precautions listed in this handbook and all other generally recognised regulations on safety must be observed at all times.

Use of non standard parts or any arbitrary modifications carried out on this machine may relieve Hayter Limited of liability for any resulting damage or injury.

Hayter mowers are robustly constructed and designed for efficient economical performance under normal mowing conditions. Correct operation and maintenance will ensure a long and satisfactory service life. Prior to despatch from our factory every effort is made to ensure that your mower is delivered in perfect condition.

Throughout this handbook all references to **left** and **right** are as viewed from behind the handlebar, in the direction of forward travel.

This handbook is based on information available at the time of publication.

HAYTER LIMITED reserve the right to amend product specifications without prior notification.

Please be advised that the illustrations in this Handbook are generic and not specific to your product.

SAFETY COMPLIANCE

To ensure low noise and vibration levels, carry out the following procedures correctly:

- To prevent overloading the engine, use the correct height of cut and ground speed (where applicable).
- Follow the recommended maintenance instructions.
- Do not use your mower for prolonged periods of time.
- Always wear hearing protection.

VIBRATION INFORMATION

Hand / Arm Vibration Level at the Operator Position measured in accordance with European Standard EN ISO 5395:2013.

	617	619
Measured Vibration Level ahw	6 ms ⁻²	6 ms ⁻²
Uncertainty of measurement K	3 ms ⁻²	3 ms ⁻²

SOUND PRESSURE INFORMATION

Sound Pressure Level at the Operator Position measured in accordance with European Standard EN ISO 5395:2013.

	617	619
Measured Sound Pressure Level LpA	84 dB (A)	84 dB (A)
Uncertainty of measurement K	2 dB (A)	2 dB (A)

SOUND POWER INFORMATION

Sound Power Level measured in accordance with European Standard EN ISO 5395:2013.

	617	619
Measured Sound Power Level LwA	93 dB (A)	93 dB (A)
Uncertainty of measurement K	3 dB (A)	3 dB (A)

For a full range of products and to locate your nearest authorised sales stockist, service or parts dealer please visit our website at www.hayter.co.uk

MAIN FEATURES

SPECIFICATIONS

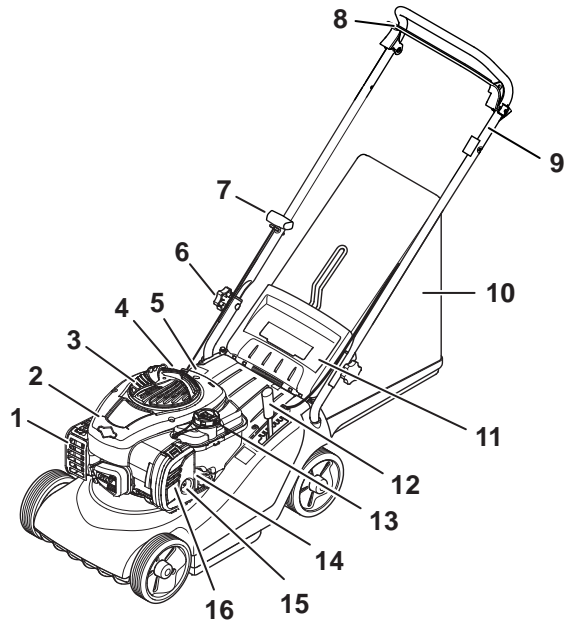

- | | |
|----------------------------|----------------------------|
| 1. Exhaust Guard | 9. Handlebar |
| 2. Engine Cover | 10. Grassbag |
| 3. Finger Guard | 11. Rear Deflector |
| 4. Oil Filler and Dipstick | 12. Height of Cut Adjuster |
| 5. Serial No. Label | 13. Fuel Tank and Cap |
| 6. Handlebar Securing Knob | 14. Stop Switch |
| 7. Engine Start Grip | 15. Primer |
| 8. Engine Stop Lever | 16. Air Cleaner |

Code	617	619
Weight	29 kg	31 kg
Length	1370 mm	1370 mm
Width	472 mm	472 mm
Height	1050 mm	1050 mm
Width of Cut	410 mm	410 mm
Height of Cut (7 positions)	13 - 65 mm	13 - 65 mm
Cutterblade Speed	2850 rpm	2850 rpm
Engine	Briggs & Stratton	Briggs & Stratton
Engine Type	Series 450E	Series 450E
Engine Power Rating (Net)	1.75 kw	1.75 kw
Fuel Type	Unleaded Petrol	Unleaded Petrol
Fuel Capacity	0,75 litre	0,75 litre
Oil Type	SAE 30	SAE 30
Oil Capacity	0,44 litre	0,44 litre

SAFETY SYMBOLS

Description: Safety alert be aware to the possibility of injury

Part Number: 111-0083



Description: Stop the engine and remove the spark plug before working on the mower

Part Number: 111-0083

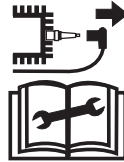

Description: Carefully read the Owners Handbook before using the machine

Part Number: 111-0083



Description: Danger of being hit by thrown objects

Part Number: 111-0083



Description: Keep bystanders at a safe distance from the mower

Part Number: 111-0083



Description: Danger of severing toes or fingers in cutting mechanism

Part Number: 111-0083



Description: Engine stop

Part Number: Moulded onto engine stop lever



Description: Height of Cut

Part Number: 320006



SAFETY PRECAUTIONS

Safety Alert Symbol

This safety alert symbol indicates important safety messages. When you see this symbol be alert to the possibility of injury. Carefully read the following and inform others.

Your mower is perfectly safe if used correctly. Failure to observe the following precautions may result in serious injury.

Training

Before using the mower read the owners handbook carefully. Pay particular attention to the safety precautions. Ensure that you are familiar with the controls and the proper use of the equipment. Learn how to stop the mower quickly in an emergency.

Never allow children or people unfamiliar with these instructions to use the mower. Local regulations can restrict the age of the operator.

Never mow while people, especially children, or pets are nearby.

Keep in mind that the user is responsible for accidents or hazards occurring to other people or their property.

All operators and mechanics should be trained. The owner is responsible for training users. Do not operate the machine under the influence of alcohol or drugs.

Preparation

Whilst mowing, always wear substantial slip resistant footwear and long trousers. Do not operate the equipment when barefoot or wearing sandals.

Thoroughly inspect the area where the mower is to be used and remove all objects which may be thrown by the machine.

WARNING: Petrol is highly flammable:

- Store fuel in containers specifically designed for this purpose
- Refuel outdoors only and do not smoke while refuelling;
- Add fuel before starting the engine. Never remove the cap from the fuel tank or add petrol while the engine is running or when the engine is hot;
- If petrol is spilt, do not attempt to start the engine but move the machine away from the area of spillage and avoid creating any source of ignition until the petrol vapours have dissipated;
- Replace all fuel tank and container caps securely;
- Always use fresh fuel which contains 10% or less ethanol. Stale fuel can block the carburettor and cause leakage. High levels of ethanol can cause engine damage.

Replace faulty exhaust.

Replace faulty silencers.

A damaged cutterblade or loose fixing bolt are major hazards. Before use, always visually inspect the cutting mechanism to ensure that it is in good condition. A damaged cutterblade must be replaced immediately with a genuine Hayter replacement part.

Do not tamper with or disable the mower safety systems, sealed adjusters or other features.

Before use, ensure that all starting interlocks and operator presence controls are properly functioning. Refer to Operating the Mower.

Do not alter or tamper with the engine speed control.

Operation

Do not operate the engine in a confined space where exhaust fumes (carbon monoxide) can collect.

Always pull the starter cord slowly until resistance is felt. Then pull the cord rapidly to avoid kickback and prevent hand or arm injury.

Mow only in daylight or good artificial light.

Avoid using the machine on wet grass, where feasible. Always be sure of your footing on slopes.

Walk, never run.

Do not operate the mower near drop-offs, ditches or embankments.

Do not mow excessively steep slopes of more than 20° and mow across the face of slopes, never up and down.

Exercise extreme caution when changing direction.

Use extreme caution when reversing or pulling the mower towards you.

Always replace worn or faulty parts with genuine Hayter parts.

This machine contains spring loaded assemblies which could cause a hazard when disassembled and re-assembled, this maintenance should only be carried out by a Hayter authorised dealer.

If the machine has to be tilted for transportation when crossing surfaces other than grass, and when transporting the machine to and from the area to be mowed, stop the blades by releasing the engine stop lever and ensure that the blades have stopped before tilting the mower.

SAFETY PRECAUTIONS

Operation *cont*

Never operate the machine with defective guards, or without safety devices, for example deflectors and/or grass bag in place.

Do not change the engine governor settings or overspeed the engine.

Start the engine carefully, with feet well away from the cutterblade and always disengage the rear roller drive clutch before starting the engine.

Do not tilt the mower when starting the engine.

Do not start the engine if standing in front of the discharge chute.

Do not put hands or feet near or under rotating parts.

Never pick up, carry the mower or lift the rear deflector whilst the engine is running.

Never touch the exhaust / exhaust guard or cooling fins when the engine is hot.

THE CUTTERBLADE CAN CONTINUE TO ROTATE AFTER THE MACHINE IS SWITCHED OFF.

Stop the engine and disconnect the spark plug lead:

- Before clearing blockages or unclogging the discharge chute;
- Before cleaning / checking or working on the machine;
- After striking a foreign object. Inspect the machine for damage and ensure necessary repairs are made before re-starting and operating;
- If the machine starts to vibrate abnormally (check immediately).

Stop the engine:

- Whenever you leave the mower;
- Before refuelling.

Take care when loading or unloading the mower into a trailer or truck. Tie the mower down securely using straps, chains, cable or ropes. Both the front and rear straps should be directed down and outward from the mower.

Lightning can cause severe injury or death. If lightning is seen or thunder is heard in the area, do not operate the mower; seek shelter.

Do not operate the mower near drop-offs, ditches or embankments.

Maintenance & Storage

Keep all nuts, bolts and screws tight to ensure that the equipment is in safe operating condition.

Frequently check fuel lines and fittings for cracks or leaks and replace if necessary.

Inspect the exhaust periodically and replace if worn or leaking.

Check the rear deflector and grassbag frequently for wear or deterioration.

Replace worn or damaged parts for safety.

Wear strong work gloves when removing and reassembling the cutterblade.

Never store the mower with petrol in the tank within an enclosed area where fumes may reach an open flame or spark.

Allow the engine to cool before storing in any enclosure.

To reduce the fire hazard, keep the engine and the surrounding

deck area free of grass, leaves or excessive grease.

If the fuel tank has to be drained, this should be done outdoors and when the engine is cool.

ASSEMBLING THE MOWER BEFORE FIRST USE

Delivery Checklist

Remove the mower from the packaging and check that the following items have been supplied correctly. If any items are missing, contact your local Hayter dealer.

1. Engine Handbook
2. Grassbag Assembly
3. Parts List
4. Declaration of Conformity

To prevent accidents cut off the long ribbon attached to the grassbag and discard.

(Refer fig.1)

Handlebar

Unscrew the handlebar securing knobs sufficiently to allow the handlebar to pivot. Hold the engine stop lever in towards the handlebar and unfold the handlebar to the operating position, then release. Ensure the knobs are assembled to the outside of the handlebar.

Tighten all handlebar knobs to secure in position.

(Refer fig.2)

Take care to ensure that the power cable does not become snagged at the pivot points.

Grassbag Assembly

- Insert the metal frame into the grassbag fabric.
- Clip into position.

(Refer fig.3)

Grassbag Attachment

Once the grassbag (3) is assembled, raise the rear deflector (1), pass the grassbag through the handlebar and hook into position (2). Lower the rear deflector to rest on the grassbag.

(Refer fig.4)

Prevent Engine Damage

To prevent engine damage the engine is shipped without oil or petrol. The engine must be filled with the correct grade of oil and petrol before starting the engine. Please refer to your engine manual for more information.

Oil Type

Always use high quality detergent oil classified SAE 30 oil. Never use additives with recommended oil. To prolong the life of your engine it is important that the oil is changed after the first 5 hours of use. Please refer to the Maintenance Schedule in this Handbook.

(Refer fig.5)

Check Oil Level

Place engine level.

Clean the oil fill area of any debris.

- Remove the dipstick and wipe with a clean cloth.
- Insert and tighten the dipstick.
- Remove the dipstick and check the oil level. It should be at the top of the full indicator on the dipstick.
- If low, add oil slowly into the engine oil fill. Do not overfill. After adding oil, wait one minute and then recheck the oil level.
- Replace and fully tighten dipstick.

(Refer fig.6)

Fig. 1

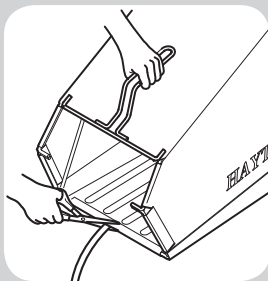

Fig. 2

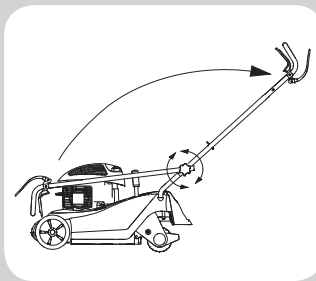

Fig. 3

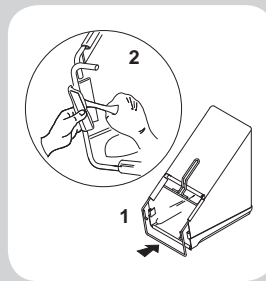

Fig. 4

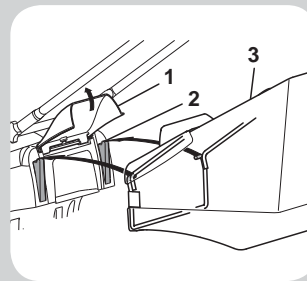

Fig. 5

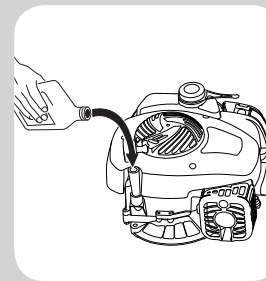
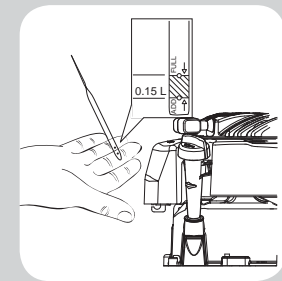

Fig. 6



OPERATING THE MOWER

Fuel Type

Purchase fuel in quantities that can be used in 30 days.

Fuel must meet these requirements:

- Clean, fresh, unleaded petrol.
- A minimum of 87 octane / 87 AKI (91 RON).
- Petrol with up to 10% ethanol is acceptable.

CAUTION: Do not use unapproved fuels, such as E15 and E85. Do not mix oil in fuel or modify the engine to run on alternate fuels. Use of unapproved fuels will damage the engine components and void the engine warranty.

To protect the fuel system from gum formation, mix a fuel stabiliser into the fuel. All fuel is not the same. If starting or performance problems occur, change fuel providers or change brands. The engine is certified to operate on petrol.

Fill to base of neck to allow for fuel expansion. Do not overfill the fuel tank.

(Refer fig.7)

Controls

Operate all control levers several times and ensure that the cables move freely. Check that the engine stop lever returns freely to its rest position when released.

(Refer fig.8)

Starting - Step 1

Operate the primer bulb (1).

Push on the primer bulb (1) five times at two second intervals to provide the extra fuel to start the engine after assembling the mower for the first time.

(Refer fig.9)

In normal use push on the primer bulb 3 times at 2 second intervals to provide extra fuel required to start a cold engine. Operation of the primer bulb is usually unnecessary when starting a warm engine.

Note: If you push the primer too many times, excessive fuel will flood the carburettor and the engine will be difficult to start.

Starting - Step 2

Stand behind the mower and hold the handlebar together with the engine stop lever with your left hand. Firmly hold the engine start grip. Pull the engine starter grip slowly until resistance is felt, then pull rapidly.

Carefully return the start grip to the storage position when the engine starts.

(Refer fig.10)

If the engine does not start after five attempts, refer to Trouble Shooting.

The engine stop lever must be held firmly against the handlebar to start and keep the engine running. If the engine stop lever is released the engine will stop.

To prevent damage, never pull the engine start grip when the engine is running.

Forward Travel (617 Only)

Hold and push against the handlebar with both hands to move the mower forwards.

(Refer fig.11)

Forward Travel (619 Only)

Hold the handlebar and operate the ground drive clutch lever to power the mower forwards.

(Refer fig.11)

When the ground drive clutch lever is disengaged the mower may be pushed. This feature is useful when mowing in confined areas.

Reverse Travel

Hold and pull against the handlebar with both hands to reverse the mower.

Fig. 7

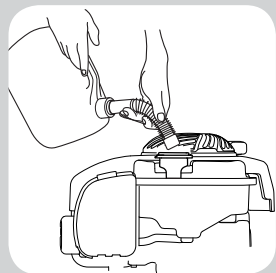

Fig. 8

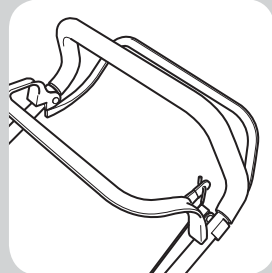

Fig. 9



Fig. 10

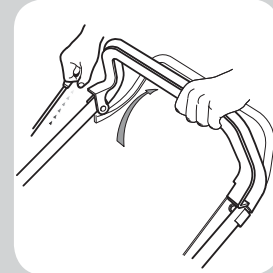
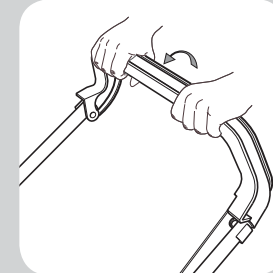

Fig. 11



OPERATING THE MOWER

Turning

To make a wide turn, steer the mower with the handlebar in the direction required.

To make a tight turn, release the ground drive clutch lever, apply downward pressure on the handlebar to raise the front wheels just above ground level and steer in the required direction.

To prevent accidents do not raise the front of the mower excessively when making a turn. Never raise the rear of the mower when the engine is running.

Stopping (617 Only)

Release the engine stop lever.

Stopping (619 Only)

Release the ground drive clutch lever and release the engine stop lever.

Emergency stop: Release both the ground drive clutch lever and the engine stop lever together.

If the engine fails to stop, disconnect the spark plug lead.
(Refer fig.12)

Slopes

To prevent engine damage, do not use the mower on slopes greater than 20 degrees.
(Refer fig.13)

Height of Cut

To adjust the height of cut: Grip the lever and pull sideways to disengage it from the locking notch, then push forwards to lower or pull backwards to increase the height of cut. Finally release the lever at the required position and ensure it locks firmly into one of the seven setting notches.

Always select a height of cut to suit operating conditions. Aim to prevent engine overloading and blockages by avoiding low cuts in long grass conditions. Be prepared to make two cuts when the grass is long.
(Refer fig.14)

Before Mowing

To prevent accidents, thoroughly inspect the area and remove all objects which when contacted by the mower cutterblade could become dangerous projectiles. Inspect the area for hidden obstructions which when contacted by the cutterblade could risk health and safety or result in damage to the mower. Remember the location of these obstructions

and ensure that you mow around them.
(Refer fig.15)

Grassbag

Raise the rear deflector, lift the grassbag through the handlebar and hook into position. Lower the rear deflector to rest against the rear of the mower.

To empty the grassbag, pour out the grass clippings and shake the grassbag vigorously to clean the airways. Good grass collection depends on good air flow through the grassbag. When collecting grass clippings it is important that the grassbag is emptied regularly to prevent blockages and engine overloading.
(Refer fig.16)

Without Grassbag Collection

Remove the grassbag and operate the mower with the rear deflector in the closed position.
(Refer fig.17)

Fig. 12

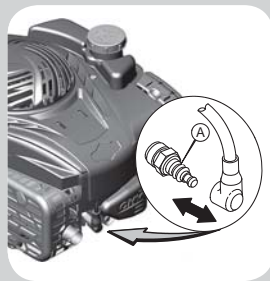

Fig. 13

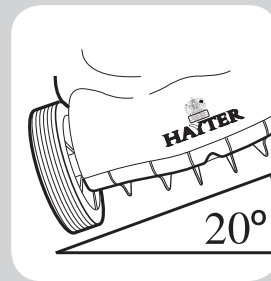

Fig. 14

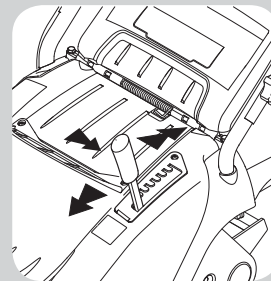

Fig. 15

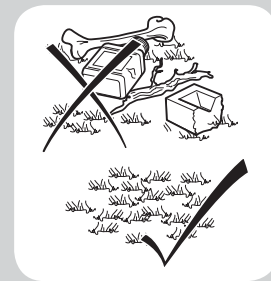

Fig. 16

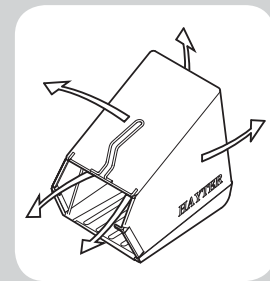
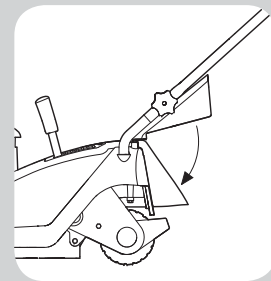

Fig. 17



OPERATING THE MOWER

Heavy Growth

Areas of heavy growth should be mown without collecting the clippings. If collection is required, first mow the area without the grassbag at the maximum height of cut setting. Allow the grass clippings to dry out and then mow the area at the maximum height of cut setting with the grassbag fitted. Reduce the height of cut and mow the area again as necessary until the required finish is obtained.

(Refer fig.18)

To prevent damage to your lawn do not remove more than one third of grass height in one cut.

Friction Disc

The cutterblade is driven by the engine via a friction disc to help prevent engine damage occurring to the engine crankshaft and the cutting mechanism when a hidden obstruction or overload is encountered.

(Refer fig.18)

Always stop the engine when a hidden obstruction or excessive vibration is encountered. Disconnect the spark plug lead and examine the cutting mechanism. ALWAYS replace a damaged cutterblade. Refer to Maintenance.

Non Grassed Areas

When moving the mower across non-grassed areas, stop the engine and set the mower to the maximum height of cut to protect the cutting mechanism.

(Refer fig.19)

Fig. 18

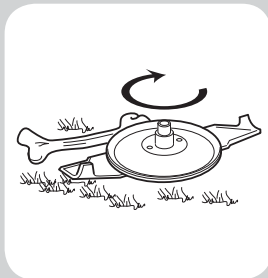
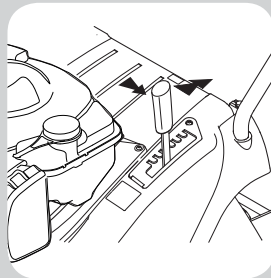

Fig. 19



MAINTENANCE SCHEDULE

Maintenance Schedule

Follow the hourly or calendar intervals, whichever occurs first. More frequent service will be required if working for prolonged periods under dusty, dry conditions, when airborne debris is present or after extensive operation cutting tall, dry grass.

First 5 Hours

- After the very first five hours change the engine oil.
- Adjust the autodrive clutch cable.

Daily

- Check the oil level.
- Remove grass debris from around the engine, exhaust / exhaust guard, air ways in the top cowl and the underside of the deck housing.
- Check the condition of guards and safety devices.
- Check condition of cutterblade.
- Check condition of grassbag and ensure airways are clear (replace if damaged).

25 Hours Or Every Season

- Change the engine oil if continuously operating under heavy load or high ambient temperature.
- Service the air cleaner.
- Lubricate wheels, pivot points and linkages.
- Grease the inner control cables at point of entry and exit from their outer casing.
- Check the clutch cable adjustment.

- Sharpen the cutterblade.

50 Hours Or Every Season

- Change the engine oil.

100 Hours Or Every Season

- Clean the engine cooling system. Clean more often under dusty conditions or when airborne debris is present or after prolonged operation whilst cutting tall, dry grass.
- Replace the spark plug.

MOWER MAINTENANCE

Engine Detail

(Refer fig.20)

Carburettor Adjustments

Never make adjustments to the carburettor or engine speed. The carburettor was set at the factory to operate efficiently under most conditions. Do not tamper with the governor spring, linkages, or other parts to change the engine speed. If any adjustments are required contact a Briggs and Stratton Authorised Service Centre for service.

Oil Service

Check the oil level daily before starting the engine and ensure that the correct oil level is maintained. Refer to Assembling the Mower Before First use for oil checking and filling instructions.

Change the engine oil after the first five hours of operation and thereafter according to the Maintenance Schedule.

Drain the fuel by running the engine until the fuel tank is empty. The oil must be drained from the top oil fill tube.

With engine off but still warm, disconnect the spark plug lead and keep it away from the spark plug.

Remove the dipstick.

When you drain the oil from the top fill tube, keep the spark plug end of the engine up. Drain the oil into an approved container.

Refill with new oil of the recommended SAE viscosity grade. Refer to Assembling the Mower Before First use.

(Refer fig.21)

Air Cleaner Service

The air cleaner system uses a foam element that can be washed and reused.

- Open the cover (A).
- Remove the foam element (B).
- Wash the foam element in liquid detergent and water. Squeeze dry the foam element in a clean cloth.
- Saturate the foam element with clean engine oil. To remove the excess engine oil, squeeze the foam element in a clean cloth.
- Install the foam element (B).
- Close the cover (A).

(Refer fig.22)

- Do not use petroleum solvents.
- Do not use pressurised air.
- Do not oil the cartridge.

Spark Plug Service

Use only Briggs and Stratton spark tester (1) to check for a spark as shown in the diagram.

(Refer fig.23)

Replace the spark plug every 100 hours or every season, whichever occurs first. A spark plug wrench is available from any authorised Briggs & Stratton service dealer.

Check the spark plug gap with a feeler gauge and set at 0.5 mm. (Refer fig.24)

Fig. 20

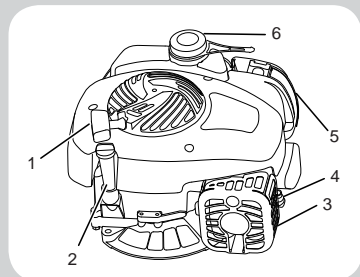

1. Engine Start Grip
2. Oil Fill / Dipstick
3. Exhaust Guard
4. Spark Plug / Lead
5. Air Cleaner
6. Fuel Cap

Fig. 21

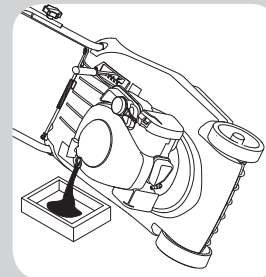

Fig. 22

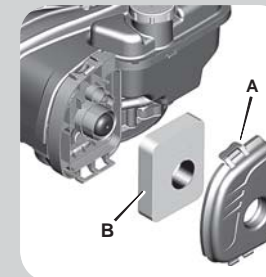

Fig. 23

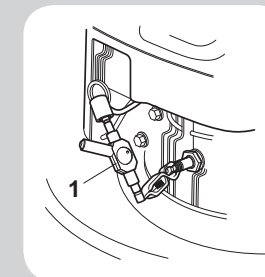
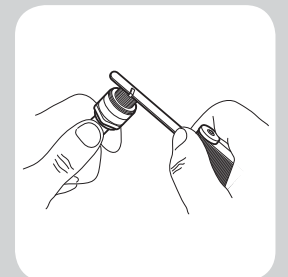

Fig. 24



MOWER MAINTENANCE

Keeping Engine Clean

Remove all grass and debris from the engine including the exhaust / exhaust guard, the air ways in the top cowl and the surrounding deck areas on a daily basis after use. Never spray the engine with water during cleaning. Water can contaminate the fuel. Always clean with a brush or compressed air.

(Refer fig.25)

Grass and debris may clog the engine's air cooling system especially after prolonged operation while cutting tall, dry grass. The internal cooling fins and surfaces may require cleaning to prevent overheating and engine damage. We recommend that this service be carried out by an authorised Briggs and Stratton dealer.

Grassbag

Remove grass debris from the grassbag immediately after use and check its condition for signs of damage.

To prevent accidents replace a damaged grassbag immediately.

(Refer fig.26)

Deck Housing

Remove grass debris from the top and underside of the deck housing immediately after use.

(Refer fig.27)

Fertilisers and top dressings are particularly corrosive. Thoroughly clean the mower deck immediately after use on treated grass and store well away from corrosive materials.

Securing Nuts & Bolts

Regularly check that all securing nuts and bolts are tight. Replace missing or damaged items immediately.

Clutch Cable Adjustment (619 only)

Check the clutch cable operation after the first hour and then every 25 operating hours and adjust if necessary. The clutch cable is adjusted correctly when the drive engages with the clutch lever positioned 55-70mm from the handlebar.

(Refer fig.28)

Set the adjuster (1) as necessary.

(Refer fig.29)

Lubrication

Lubricate the wheels, pivot points and linkages with engine oil every 25 operating hours.

Apply a good quality medium grease to the inner control cables,

at the point of entry and exit from their outer casting.

Cutterblade Removal

Drain the fuel by running the engine until the fuel tank is empty and the engine stops.

Remove the spark plug lead and allow the engine to cool. Turn the mower on to its right hand side and ensure that the air cleaner side of the engine is uppermost.

Firmly grip the end of the cutterblade with a gloved hand and remove the bolt, spring washer and distance piece securing the cutterblade with a 9/16" A/F spanner.

(Refer fig.30)

To prevent accidents, never work on the cutterblade unless the spark plug lead has been removed. The cutterblade has sharp edges. ALWAYS wear strong gloves to protect your hands when working on the cutterblade. DO NOT rotate tools towards the cutting edges to avoid the risk of injury should the tool slip. ALWAYS use genuine Hayter replacement parts.

The condition of the cutterblade and its mounting arrangement should be checked regularly for signs of wear or damage. Ensure that the cutterblade is not bent or cracked.

Fig. 25

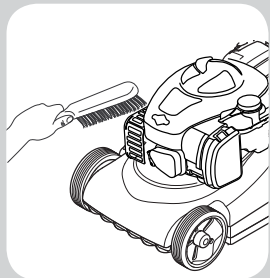

Fig. 26

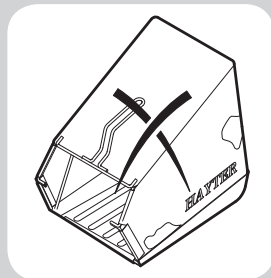

Fig. 27

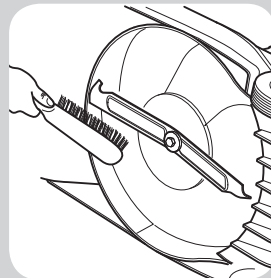

Fig. 28

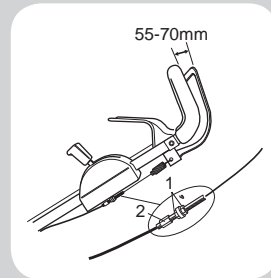

Fig. 29

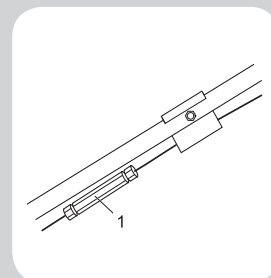
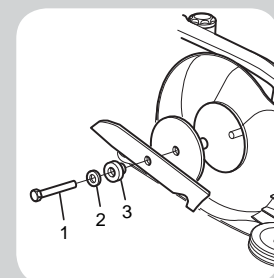

Fig. 30



MOWER MAINTENANCE

Cutterblade Removal continued

A damaged cutterblade that is out of balance will vibrate excessively and may break. DO NOT use an unbalanced cutterblade.

Regularly check that the bolt securing the cutterblade is tightened to the specified torque of 54Nm.

Replace the cutterblade every 2 years or sooner or excessively worn or damaged.

To prevent injury it is wise to seek assistance when turning the mower on its side.

Cutterblade Assembly

Assemble the cutterblade with the turned up edges facing towards the engine. Secure the cutterblade using the bolt (1), spring washer (2), distance piece (3) and tighten to a torque of 54Nm.

(Refer fig.30)

Cutterblade Sharpening

A slightly worn cutterblade may be re-sharpened. Both blade edges must be sharpened equally to ensure balance. Sharpen the cutterblade every 25 mowing hours or more frequently if

conditions require. Remove the cutterblade from the mower and clean using a brush and water.

Inspect the cutterblade for signs of damage.

Sharpen both cutting edges with a flat file to restore performance.

(Refer fig.31)

Ensure that the cutterblade is balanced. Use a screw driver with a round shaft to support the cutterblade through its centre hole. Hold the cutterblade horizontal and then release. A balanced cutterblade will remain horizontal.

(Refer fig.32)

If the cutterblade is not balanced the heavy end will rotate downwards. Sharpen the heavy end until the cutterblade is correctly balanced.

(Refer fig.33)

Storage

To store the handlebar, unscrew the 2 small securing knobs sufficiently to allow it to be pivoted forwards to rest against the mower. Take care to ensure that the control cables do not become snagged at the pivot point and depress the engine stop lever to prevent it being damaged through contact with the engine spark plug.

(Refer fig.34)

Engines stored in excess of 30 days need to be protected with Briggs & Stratton fuel additive or drained of fuel to prevent gum

from forming in the fuel system or on essential carburettor parts. To ensure your mower is maintained in good working order it is important that the following procedure is adopted. Refer to Maintenance section as necessary.

Drain fuel from the engine by operating the engine until it stops.

Disconnect the spark plug lead.

Change the engine oil.

Remove the engine spark plug and pour 15ml of engine oil into the cylinder and replace the spark plug. Do not exceed the stated volume of oil as engine damage may occur on restarting. Do not replace the spark plug lead. Slowly pull the engine start grip once to crank the engine. This will distribute the oil and help prevent engine corrosion.

Clean grass and debris from the engine cylinder, cylinder head cooling fins, under top cowl, around and behind exhaust / exhaust guard and ensure that the grassbag is clean.

Lubricate the mower and treat metal parts with a water repellent anti-corrosion product.

Cover the mower with a protective sheet and store it in a dry, ventilated area.

Fig. 31



Fig. 32

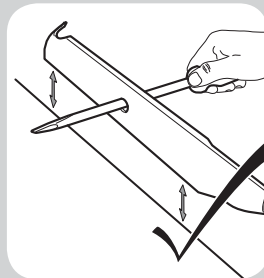

Fig. 33

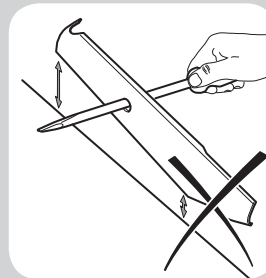
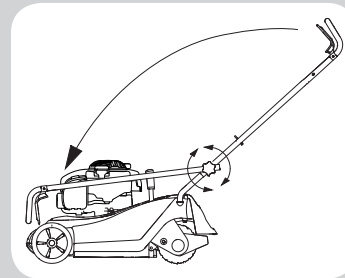

Fig. 34



LAWN CARE CALENDAR To be used as a guide only

January

There is very little work to do this month apart from brushing away leaves. Keep off the grass if frozen or waterlogged.

February

Rake the grass thoroughly. Spike the lawn to aerate and stimulate soil organisms and root growth and apply lawn sand if necessary.

March

The yearly lawn work programme really starts this month. As soon as the ground conditions are suitable, the first cut can be made. The first cut should merely “top” the grass as close cutting at this stage could result in severe yellowing or browning. Two cuts are generally sufficient this month.

April

Mow often enough to stop grass growing away. Dig out patches of coarse grass or resistant weed. Re-seed bare patches.

May

Keep mowing increasing the frequency as required. Treat with selective weed killers or combined weed/feed preparations if you did not feed the lawn in April.

June

Summer mowing should now be under way. It should be necessary to mow the lawn twice a week. Raking before mowing is important this month as the combined action keeps runners of clover under control. Water the grass if necessary, and remember to soak thoroughly.

July

Treat the grass with the second application of fertiliser or weed killer/fertiliser. Water when necessary and rake occasionally. As a general rule the grass clippings should be removed each time you mow. If weather conditions are dry and hot and the grass is weed free, leave the clippings on the lawn to help maintain ground moisture.

August

Keep mowing regularly and watering as necessary. Fill any cracks caused by drought with a mixture of sharp sand and soil. In dry weather conditions leave the grass longer to help retain ground moisture.

September

Raise the height of cut to allow the grass to thicken and protect the roots from the winter frost and snow.

October

Rake out the thatch from the turf and spike the lawn to assist in drainage. Brush in peat and sharp sand.

November

Use a stiff broom to disperse worm casts before mowing. Keep turf free from leaves.

December

Apart from brushing away leaves, December is a slack end of a busy year. Keep off the lawn if it is very wet or frozen.

Lawn Stripes

The way to achieve a neat striped effect is for the lawn being cut in parallel stripes, alternate stripes being mown in opposite directions. A much more important routine is to cut at right angles to the line of the previous mowing. If the work has been carried in a north-south line, then the next cutting should be in an east-west direction. The cross-cutting keeps down the coarse weed grasses.

To prevent grass damage do not remove more than one third of the grass height in one cut.

TROUBLE SHOOTING

PROBLEM	CAUSES	CORRECTIVE ACTION
Engine will not turn over	Engine stop lever released	Operate engine stop lever
	Incorrect oil level	Check oil level
	Obstruction under deck	Remove obstruction
Engine smokes	Excess oil	Check oil level
	Air cleaner cartridge oil soaked or blocked	Service air cleaner
Engine runs then stops	Fuel starvation	Fill fuel tank
	Fuel cap vent blocked	Clean fuel cap vent
Engine will not start	Engine under load	Raise the height of cut
	Incorrect / contaminated fuel	Drain tank and fill with correct fuel
	Spark plug lead disconnected	Connect spark plug lead
	Engine brake not released	Operate engine brake lever
	Faulty spark plug	Clean and adjust the gap or replace
Engine runs rough	Spark plug lead becoming disconnected in use	Connect spark plug lead
	Faulty spark plug	Clean and adjust gap or replace
	Air cleaner blocked	Service air cleaner
	Incorrect / contaminated fuel	Drain tank and fill with correct fuel
Engine vibrates excessively	Mounting bolt loose	Tighten bolt
	Cutterblade bolt loose	Tighten bolt
	Cutterblade out of balance	Balance cutterblade
	Bent crankshaft	Consult your dealer

PROBLEM	CAUSES	CORRECTIVE ACTION
Uneven cut	Undulating ground conditions	Change direction of travel
	Cutterblade worn	Sharpen cutterblade
	Cutterblade out of balance	Balance the cutterblade
	Wheels/roller damaged	Inspect and replace as necessary
Discharge chute blocks	Grass is wet	Mow dry grass
	Cut height too low	Increase cut height
	Grassbag full	Empty grassbag
	No airflow through the grassbag	Clean the grassbag
Mower is hard to push	Cut height too low	Increase cut height
	Wheels/roller damaged	Inspect and replace as necessary
Mower will not self propel	Clutch out of adjustment	Adjust clutch cable
	Drive belt damaged	Replace drive belt
Poor grass condition	No airflow through the grassbag	Clean the grassbag
	Discharge chute blocked	Remove blockage
	Wet grass	Mow dry grass
	Grassbag full	Empty grassbag
Cutterblade drive will not engage/disengage	Engine stop lever not fully forward	Push fully forward to disengage

WARRANTY

3 Year Limited Warranty - Home Owner 90 Day Warranty Commercial Use

Hayter Limited warrants to the original user/purchaser that this unit shall be free from defects in material and workmanship under normal use and service for a period of one year from the date of purchase. The manufacturers of the engine furnish their own warranty and services are provided through their authorised network (Refer to “Engine Warranty Statement”). To qualify for the full benefit of the warranty, the Warranty Registration Card must be returned to Hayter Limited within 14 days of purchase. If the selling dealer has not returned the Warranty Registration Card please complete and return. Subject to the conditions and exclusions noted in this limited warranty, we shall at our option, repair or replace any part covered by the warranty during the applicable period. If you are in doubt or experience any difficulty, please consult a Hayter Authorised Service Dealer for clarification.

This warranty does not apply to any unit that has been tampered with, altered, misused, abused or used for hire, and will become invalid if non genuine Hayter parts are fitted. This warranty does not cover for minor mechanical adjustments unless they are due to defective material or workmanship. Consult the Owner’s Handbook or a Hayter Authorised Service Dealer for assistance when making these adjustments.

Extended 3 Year Warranty

To qualify for the extended warranty period (second and third year) of the three year limited warranty the machine must have an annual service carried out by an Authorised Hayter Service Dealer. These services should be carried out within 12 and 24 months of the date of purchase. Please note that these services will be charged at a rate agreed between you and the Authorised Service Dealer.

Excluded from the extended warranty period are those items which are subject to normal wear and tear including but not limited to, tyres, wheels, cutterblades, belts, cables, grassbags, batteries and other consumable wearing parts.

Commercial Use

Machines used commercially are excluded from the above warranty. A warranty period of 90 days applies.

Lifetime Warranty Against Crankshaft Bending

All consumer machines which are fitted with a genuine Hayter Friction Disc as original equipment before use, are covered by a Lifetime Warranty against the engine crankshaft bending. Note: friction washers, Blade Brake Clutch (B.B.C.) units and other such devices are excluded from the Lifetime Warranty coverage. Only machines fitted with a genuine Hayter friction disc, which are used in accordance with the recommended operating and maintenance procedures, are covered.

Making a Claim

To make a warranty claim, return the unit to a Hayter Authorised Service Dealer along with proof of purchase stating the machine serial number and date of purchase. The service receipt(s) or stamped service card must be produced as proof of entitlement to the extended warranty period. Subject to the conditions and exclusions in this limited warranty, the Authorised Service Dealer will, at our option, repair or replace any warranted part within the duration of the warranty period.

This limited warranty gives you specific legal rights and is in addition to any statutory rights to which you may be entitled and your statutory rights are not affected by this warranty. If you need additional information concerning this written warranty, or assistance in obtaining services, please write to: HAYTER LIMITED, Service Department, Spellbrook, Bishop’s Stortford, Hertfordshire CM23 4BU

UK ONLY: Details of your local Hayter Authorised Dealer can be found on the Hayter website www.hayter.co.uk or contact: Freephone 0800 616298.

The Information Hayter Collects

This warranty is jointly administered by Hayter Limited (Hayter) and its affiliate, Toro Warranty Company (Toro). Hayter and Toro respect your privacy. In order to process your warranty claim and contact you in the event of a product recall, we ask you to share certain personal information with us, either directly or through your local Hayter dealer.

Your personal information will be processed by Hayter in the UK. It will also be entered into the Toro warranty system, which is hosted on servers located within the United States where privacy law may not provide the same protection as applies in your country.

BY SHARING YOUR PERSONAL INFORMATION WITH US, YOU ARE CONSENTING TO THE PROCESSING OF YOUR PERSONAL INFORMATION AS DESCRIBED IN THIS PRIVACY NOTICE.

The Way We Use Information

Hayter and Toro may use your personal information to process warranty claims, to contact you in the event of a product recall, to gauge customer satisfaction, and for any other purpose which we tell you about. We may share your information with our parent, The Toro Company, or with our affiliates, dealers or other business partners in connection with any of these activities. We will not sell your personal information to any other company. We reserve the right to disclose personal information in order to comply with applicable laws and with requests by the appropriate authorities, to operate our systems properly or for our own protection or that of other users.

Retention of your Personal Information

We will keep your personal information as long as we need it for the purposes for which it was originally collected or for other legitimate purposes (such as regulatory compliance), or as required by applicable law.

Our Commitment to Security of Your Personal Information

Hayter and Toro take reasonable precautions in order to protect the security of your personal information. We also take steps to maintain the accuracy and current status of personal information.

Access and Correction of your Personal Information

If you would like to review or correct your personal information, please contact us by email at legal@toro.com.

June 11, 2012

SERVICE RECORDS & CUSTOMER INFORMATION

Please ensure that upon completion of each chargeable Service you retain your invoice/receipt.

1st Year (12 Months)

We certify that this service has
been carried out by an
Authorised Hayter Service Dealer

Date: _____

DEALER DETAILS

2nd Year (24 Months)

We certify that this service has
been carried out by an
Authorised Hayter Service Dealer

Date: _____

DEALER DETAILS

Date of Sale:- _____

Engine Type:- _____

Engine:- _____

DEALER DETAILS

SERIAL NUMBER LABEL

Hayter Limited

Spellbrook, Bishop's Stortford,
Hertfordshire CM23 4BU England
Tel: +44 (0)1279 723444 Fax: +44 (0)1279 600338
www.hayter.co.uk