



**HAYTER**  
MAKERS OF THE FINEST MOWERS

*Harrier 41 Push*  
*Code374A*

*OWNER'S HANDBOOK*



**Original Version (EN)**  
**Issued: 13/03/2017**

**From Serial Number: 40000000 & Up**  
**Part number: 134-0110 Rev B**



# CONTENTS

<b>Introduction</b>	<b>4</b>	Non Grassed Areas	11
<b>General Safety</b>	<b>4</b>	Height of Cut	11
<b>Product Features</b>	<b>5</b>	Grassbag	11
<b>Product Specification</b>	<b>5</b>	Collection Without Grassbag	11
<b>Safety Symbols</b>	<b>6</b>	Heavy Growth	12
<b>Safety Precautions</b>	<b>7 - 8</b>	Friction Disc	12
Safety Alert Symbol	7	<b>Mower Maintenance</b>	<b>13 - 16</b>
Training	7	Engine Detail	13
Preparation	7	Carburetor Adjustments	13
Operation	7 - 8	Oil Service	13
Maintenance & Storage	8	Air Filter Service	13
Transporting	8	Spark Plug Service	14
Spare Parts	8	Keeping Engine Clean	14
<b>Assembling the Mower Before First Use</b>	<b>9</b>	Grassbag	14
Delivery Checklist	9	Easy-Wash Port	14
Handle	9	Securing Nuts & Bolts	14
Grassbag Assembly	9	Rear Deflector	14
Prevent Engine Damage	9	Lubrication	15
Oil Type	9	Cutterblade Removal	15
Check Oil Level	9	Cutterblade Assembly	15
<b>Operating the Mower</b>	<b>10 - 12</b>	Cutterblade Sharpening	16
Fuel Type	10	Storage	16
Controls	10	<b>Maintenance Schedule</b>	<b>17</b>
Before Mowing	10	<b>Lawn Care Calendar</b>	<b>18</b>
Starting	10	<b>Trouble Shooting</b>	<b>19</b>
Forward Travel	11	<b>Warranty</b>	<b>20</b>
Reverse Travel	11	<b>EU Privacy Statement</b>	<b>21</b>
Parking	11	<b>Notes</b>	<b>21 - 22</b>
Turning	11	<b>Service Records &amp; Customer Information</b>	<b>24</b>
Stopping	11		

# INTRODUCTION

Thank you for purchasing a Hayter mower.  
The following pages are designed to help you gain safe and efficient service from your machine.

This Owner's Handbook should be regarded as part of the mower as it gives essential information regarding safety, operation, maintenance and specifications.

If you misplace your Owner's Handbook, contact your local Hayter authorised dealer for a replacement. Alternatively, visit [www.hayter.co.uk/handbooks](http://www.hayter.co.uk/handbooks) to download an electronic version.

For engine details related to your product, please refer to the engine handbook provided.

To ensure maximum safety, best performance, and to gain knowledge of the mower, it is essential that you and any other operator read and understand the contents of this handbook before the engine is started. If you are unsure of any procedure detailed in this Handbook then please contact your local Hayter dealer for assistance.

Pay particular attention to the safety alert symbol which means Caution, Warning, or Danger. Read and understand the instruction as it relates to safety.

Improper maintenance or use of this mower can result in injury.

To reduce the potential for injury, comply with these safety instructions. This mower should be operated, serviced and repaired only by persons who are familiar with its particular characteristics and who are acquainted with the relevant safety procedures.

Throughout this handbook all references to left and right are as viewed from behind the handle, in the direction of forward travel.

Hayter Limited have designed and tested this machine for reasonably safe service; however, failure to comply with the instructions in this handbook may result in personal injury. This mower is designed solely for use in a domestic grass cutting environment. Use in any other way is considered as contrary to the intended use.

Hayter Limited reserves the right to amend product specifications without prior notification.

# GENERAL SAFETY

This machine has been designed in accordance with EN ISO 5395:2013.

This product is capable of amputating hands and feet and of throwing objects. Always follow all safety instructions to avoid serious personal injury.

Using this product for purposes other than its intended use could prove dangerous to you and bystanders.

- Read and understand the contents of this Operator's Manual before starting the engine.
- Do not put your hands or feet near moving components of the machine.
- Do not operate the machine without all guards and other safety protective devices in place and working on the machine.
- Keep clear of any discharge opening. Keep bystanders a safe distance from the machine.
- Keep children out of the operating area. Never allow children to operate the machine.
- Stop the machine and shut off the engine before servicing, fuelling, or unclogging the machine.

**Improperly using or maintaining this machine can result in injury.**

**To reduce the potential for injury, comply with these safety instructions and always pay attention to the safety-alert symbol, which means Caution, Warning, or Danger - personal safety instruction.**

**Failure to comply with these instructions may result in personal injury or death.**

For a full range of products and to locate your nearest authorised sales stockist, service or parts dealer please visit our website at [www.hayter.co.uk](http://www.hayter.co.uk)

# PRODUCT OVERVIEW

# SPECIFICATION

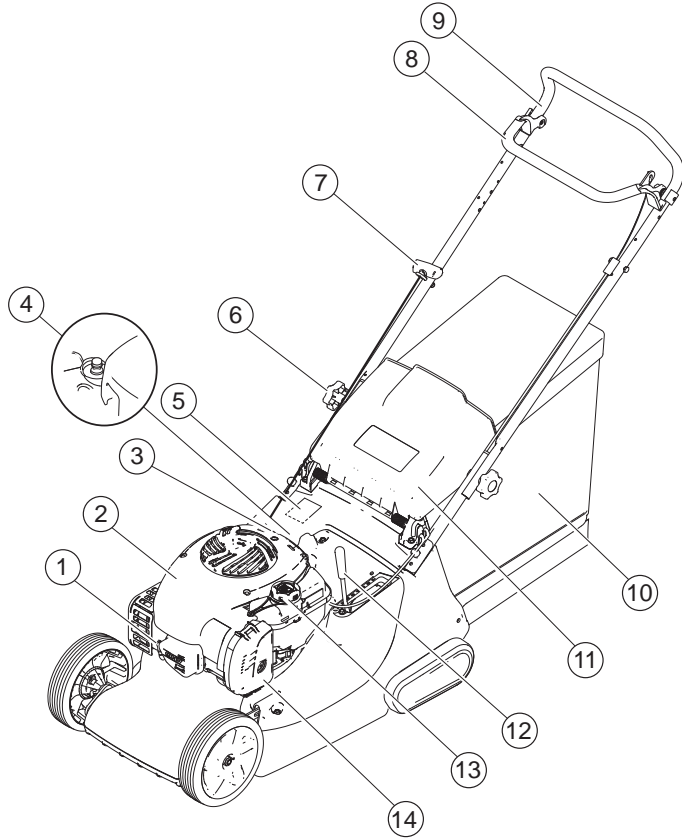

- |                          |                         |
|--------------------------|-------------------------|
| 1. Spark Plug and Lead   | 8. Engine Stop Lever    |
| 2. Engine Cover          | 9. Handle               |
| 3. Oil Fill and Dipstick | 10. Grassbag            |
| 4. Easy Wash Port        | 11. Rear Deflector      |
| 5. Serial Number Label   | 12. Height of Cut Lever |
| 6. Handle Securing Knob  | 13. Fuel Cap            |
| 7. Engine Start Cord     | 14. Air Filter          |

<b>Code</b>	374A
<b>Model</b>	Harrier 41 Push Petrol Rotary Mower
<b>Weight</b>	34 kg
<b>Length</b>	1440 mm
<b>Width</b>	485 mm
<b>Height</b>	1040 mm
<b>Width of Cut</b>	410 mm
<b>Height of Cut</b>	13 - 60 mm
<b>Cutterblade Speed</b>	2750 rpm
<b>Engine</b>	Briggs & Stratton
<b>Engine Type</b>	575EX Instart
<b>Engine Power Rating (Net)</b>	2.12 kW
<b>Fuel Type*</b>	Unleaded fuel
<b>Fuel Capacity</b>	1.5 litre
<b>Oil Type</b>	SAE 30 engine oil
<b>Oil Sump Capacity</b>	0.44 litres

\* A minimum of 87 octane / 87 AKI (91 RON).

\* Fuel with up to 10% ethanol is acceptable.

\* Do not use unapproved fuels, such as E15 and E85

# SAFETY SYMBOLS

Please ensure all Safety Decals are secured on the mower before using the product.

If any of the decals are missing or not secure, do not use the mower, contact your local Hayter authorised dealer for replacements.

**WARNING: Improper maintenance, use of non conforming spare parts, or the removal or modification of the Safety Decals may cause death or serious injury.**

**Description:** Engine stop

**Part Number:** Moulded onto engine stop lever



**Description:** Height of Cut

**Part Number:** Moulded in plastic cover

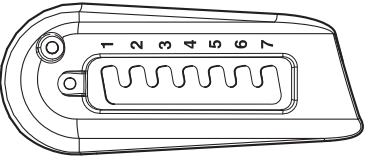
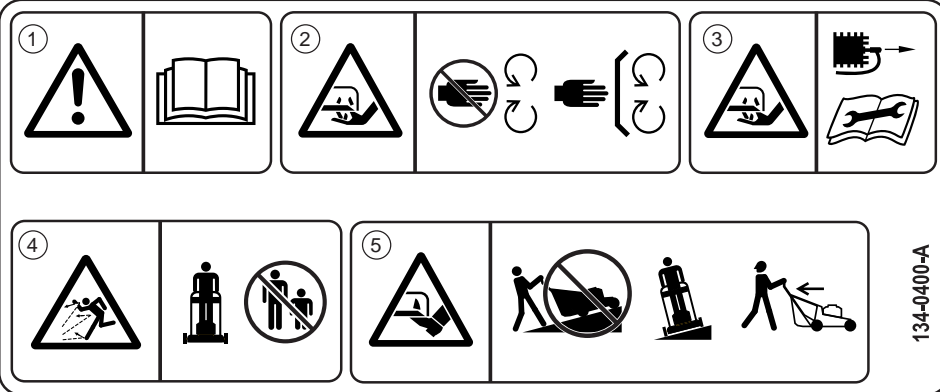
134-0400-A

1. WARNING - Read Operator's Manual
2. Cutting/dismemberment hazard of hand or foot, mower blade - stay away from movingparts; keep all guards and shields in place.
3. Cutting/dismemberment hazard of hand or foot, mower blade - disconnect the spark plug lead and read the instructions before servicing or performing maintenance.
4. Thrown object hazard - keep bystanders a safe distance from the machine; pick up any debris before mowing.
5. Cutting/dismemberment hazard of hand or foot, mower blade - do not operate up and down slopes; operate side to side on slopes; look behind you when backing up.

# SAFETY PRECAUTIONS

## Safety Alert Symbol

This safety alert symbol indicates important safety messages. When you see this symbol be alert to the possibility of injury. Carefully read the following and inform others.

Failure to observe the following precautions may result in serious injury.

## Training

Before using the mower read the owners handbook carefully. Pay particular attention to the safety precautions. Ensure that you are familiar with the controls and the proper use of the equipment. Learn how to stop the mower quickly in an emergency.

Never allow children or people unfamiliar with these instructions to use the mower. Local regulations can restrict the age of the operator.

Never mow while people, especially children, or pets are nearby.

Keep in mind that the user is responsible for accidents or hazards occurring to other people or their property.

All operators and mechanics should be trained. The owner is responsible for training users. Do not operate the machine while ill, tired or under the influence of alcohol or drugs.

## Preparation

Whilst mowing, always wear substantial slip resistant footwear and long trousers. Tie back long hair and do not wear jewellery or loose clothing.

Thoroughly inspect the area where the mower is to be used and remove all objects which may be thrown by the machine.

**WARNING:** Fuel is highly flammable and highly explosive. A fire or explosion from fuel can burn you and others, and can

damage property.

Fill the fuel tank outdoors, in an open area, when the engine is cold. Wipe up any fuel spills.

Do not handle fuel when smoking or around an open flame or sparks.

Store fuel in an approved container and keep it out of the reach of children.

A damaged cutterblade or loose fixing bolt are major hazards. Before use, always visually inspect the cutting mechanism to ensure that it is in good condition. A damaged cutterblade must be replaced immediately with a genuine Hayter replacement part.

Do not tamper with or disable the mower safety systems, sealed adjusters or other features.

Before use, ensure that all starting interlocks and operator presence controls are properly functioning. Refer to Operating the Mower.

Do not alter or tamper with the engine speed control.

## Operation

Do not operate the engine in a confined space where exhaust fumes (carbon monoxide) can collect.

Always pull the starter cord slowly until resistance is felt. Then pull the cord rapidly to avoid kickback and prevent hand or arm injury.

Mow only in daylight or good artificial light.

Avoid using the machine on wet grass.

Always be sure of your footing on slopes.

Walk, never run.

Do not operate the mower near drop-offs, ditches or embankments.

Mow across the face of slopes, never up and down.

Use extreme care when approaching blind corners, shrubs, trees, or other objects that may block your view.

Watch for holes, ruts, bumps, rocks, or other hidden objects. Uneven terrain could cause a slip-and-fall accident.

Adjusting the cutting height may bring you into contact with the moving cutter blade, causing serious injury.

- Shut off the engine and wait for all moving parts to stop.
- Do not put your fingers under the housing when adjusting the cutting height.

# SAFETY PRECAUTIONS

## Operation *cont*

This machine contains spring loaded assemblies which could cause a hazard when disassembled and re-assembled, this maintenance should only be carried out by a Hayter authorised dealer.

If the machine has to be tilted for transportation when crossing surfaces other than grass, and when transporting the machine to and from the area to be mowed, stop the blades by releasing the engine stop lever and ensure that the blades have stopped before tilting the mower.

Never operate the machine with defective guards, or without safety devices, for example deflectors and/or grass bag in place.

Do not change the engine governor settings or overspeed the engine.

Start the engine carefully, with feet well away from the cutterblade and always disengage the rear roller drive clutch before starting the engine.

Do not tilt the mower when starting the engine.

Do not start the engine if standing in front of the discharge chute.

Do not put hands or feet near or under rotating parts.

Never pick up, carry the mower or lift the rear deflector whilst the engine is running.

If the engine has been running the silencer and exhaust will be hot and can severely burn you. Keep away from the hot mower.

**THE CUTTERBLADE CAN CONTINUE TO ROTATE AFTER THE MACHINE IS SWITCHED OFF.**

**Stop the engine, disconnect the spark plug lead and remove the battery pack from the engine battery tray:**

- Before clearing blockages or unclogging the discharge chute;
- Before cleaning / checking or working on the machine;
- After striking a foreign object. Inspect the machine for damage and ensure necessary repairs are made before re-starting and operating;
- If the machine starts to vibrate abnormally (check immediately).

The cutter blade is sharp, contacting the cutter blade can result in serious personal injury. Shut off the engine and wait for all moving parts to stop before leaving the operating position.

When you release the engine stop lever, the engine should shut off and the cutter blade should stop within 3 seconds. If not, stop using your machine immediately and contact an authorized service dealer.

Lightning can cause severe injury or death. If lightning is seen in the area, do not operate the mower; seek shelter.

## Maintenance & Storage

Keep all nuts, bolts and screws tight to ensure that the equipment is in safe operating condition.

Frequently check fuel lines and fittings for cracks or leaks and replace if necessary.

Inspect the exhaust periodically and replace if worn or leaking.

Check the rear deflector and grassbag frequently for wear or deterioration.

Replace worn or damaged parts for safety.

Wear strong work gloves when removing and reassembling the cutterblade.

Never store the mower with fuel in the tank within an enclosed area where fumes may reach an open flame or spark.

Allow the engine to cool before storing in any enclosure.

To reduce the fire hazard, keep the engine and the surrounding deck area free of grass, leaves or excessive grease.

If the fuel tank has to be drained, this should be done outdoors and when the engine is cool.

## Transporting

Use care when loading or unloading the machine. Secure the machine to prevent it from moving.

## Spare Parts

Below is a list of parts that can affect the Health & Safety of the Operator:

- Cutterblade
- Grassbag
- Rear Deflector
- OPC (Engine Stop)
- Warning Decals
- Owners Handbook

For Spare Part numbers, please refer to the Hayter Parts List.

Do not add lubricant or grease to the plastic rear roller bearings.



# ASSEMBLING THE MOWER BEFORE FIRST USE

## Delivery Checklist

Remove the mower from the packaging and check that the following items have been supplied correctly. If any items are missing, contact your local Hayter dealer.

1. Engine Handbook
2. Grassbag Assembly
3. Parts List
4. Declaration of Conformity

To prevent accidents cut off the long ribbon attached to the grassbag and discard.

*(Refer fig.1)*

## Handle

**Take care to ensure that the control cables do not become snagged at the pivot points.**

Unscrew the handle securing knobs sufficiently to allow the handle to pivot. Hold the engine stop lever in towards the handle and unfold the handle to the operating position, then release.

Tighten both handle knobs to secure in position.

*(Refer fig.2)*

## Grassbag Assembly

Before first use assemble the grassbag and frame. Slide the frame (1) into the grassbag (2), ensuring that the handle is above the grassbag as shown. Attach plastic clips (A), (B), (C) and (D) to the grassbag frame.

Raise the rear deflector, lower the grassbag and hook into position. Lower the deflector to rest on the grassbag.

*(Refer fig.3)*

## Prevent Engine Damage

**To prevent engine damage the engine is shipped without oil or fuel. The engine must be filled with the correct grade of oil and fuel before starting the engine. Please refer to your engine manual for more information.**

## Oil Type

Always use high quality detergent oil classified SAE 30 oil. Never use additives with recommended oil. To prolong the life of your engine it is important that the oil is changed after the first 5 hours of use.

*(Refer fig.4)*

## Check Oil Level

Before adding or checking the oil, ensure the engine is level and the oil fill area is clear of debris.

### To add oil:

1. Remove the dipstick (A) and wipe with a clean cloth.
2. Insert and tighten the dipstick (A).
3. Remove the dipstick and check the oil level. Correct oil level is at the top of the full indicator (B).
4. If oil level is low, slowly add oil into the engine oil fill. DO NOT OVERFILL. After adding oil, wait one minute and then recheck the oil level.
5. Re-insert and tighten the dipstick (A).

*(Refer fig.5)*

Fig. 1

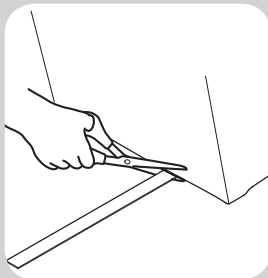

Fig. 2

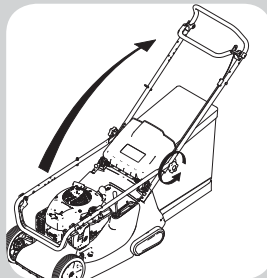

Fig. 3

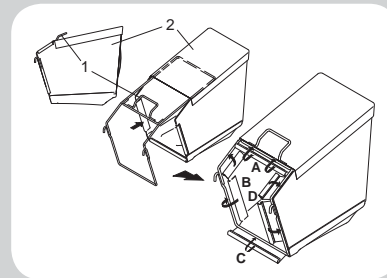

Fig. 4

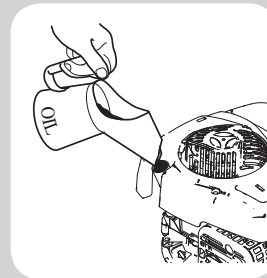
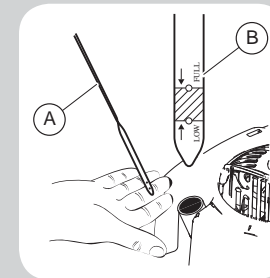

Fig. 5



# OPERATING THE MOWER

## Fuel Type

Fuel must meet these requirements:

- Clean, fresh, unleaded gasoline. Purchase fuel in quantities that can be used in 30 days.
- A minimum of 87 octane/87 AKI (91 RON). High altitude use, see below.
- Petrol with up to 10% ethanol is acceptable.

**CAUTION: Do not use unapproved fuels, such as E15 and E85. Do not mix oil in fuel or modify the engine to run on alternate fuels. Use of unapproved fuels will damage the engine components and void the engine warranty.**

To protect the fuel system from gum formation, mix a fuel stabiliser into the fuel. All fuel is not the same. If starting or performance problems occur, change fuel providers or change brands. The engine is certified to operate on petrol.

At altitudes over 5,000 feet (1524 meters), a minimum 85 octane/85 AKI (89 RON) petrol is acceptable.

For carbureted engines, high altitude adjustment is required to maintain performance.

Operation without this adjustment will cause decreased performance, increased fuel consumption, and increased emissions. Contact a Briggs & Stratton Authorised Service Dealer for high altitude adjustment information. Operation of the engine at altitudes below 2,500 feet (762 meters) with the

high altitude adjustment is not recommended.

**Fill to base of neck to allow for fuel expansion. Do not overfill the fuel tank.**

*(Refer fig.6)*

## Controls

**WARNING: Improper maintenance, use of non conforming replacement components, or the removal or modification of the control cable(s) may cause serious injury or death.**

Operate all control levers several times and ensure that the cables move freely. Check that the engine stop lever returns freely to its rest position when released.

*(Refer fig.7)*

## Before Mowing

**To prevent accidents, thoroughly inspect the area and remove all objects which when contacted by the mower cutterblade could become dangerous projectiles. Inspect the area for hidden obstructions which when contacted by the cutterblade could risk health and safety or result in damage to the mower. Remember the location of these obstructions and ensure that you mow around them.**

*(Refer fig.8)*

## Starting

Stand behind the mower and hold the handle together with the engine stop lever with your left hand. With your right hand hold the engine start cord and pull slowly until resistance is felt, release, then pull rapidly to crank the engine. Carefully return the start cord to the storage position when the engine starts.

*(Refer fig.9)*

If the engine does not start after 5 attempts - Refer to Trouble Shooting.

The engine stop lever must be held firmly against the handle to start and keep the engine running. If the engine stop lever is released the engine will stop.

**To prevent damage never pull the engine start grip when the engine is running.**

Fig. 6

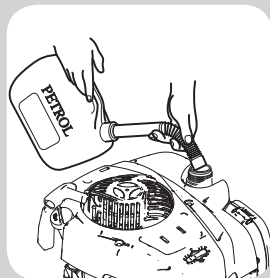

Fig. 7

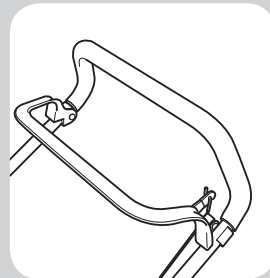
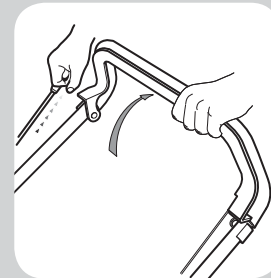

Fig. 8



Fig. 9



# OPERATING THE MOWER

## Forward Travel

Hold and push against the handle with both hands to move the mower forwards.

## Reverse Travel

Hold and pull against the handle with both hands to reverse the mower.

## Parking

Park on level ground.

## Turning

To make a turn, steer the mower with the handle in the direction required.

**To prevent accidents do not raise the front of the mower excessively when making a turn. Never raise the rear of the mower when the engine is running.**

## Stopping

Release the engine stop lever.

**Emergency stop: As above. If the engine fails to stop**

**disconnect the spark plug lead.**  
(Refer fig.10)

## Height Of Cut

**To adjust the height of cut:**

Hold the lever and pull sideways to disengage it from the locking notch, then pull backwards to raise the height of cut or push forwards to lower the height of cut. Finally release the lever at the required position and ensure it locks firmly into one of the setting notches.

Always select a height of cut to suit operating conditions. Aim to prevent engine overloading and blockages by avoiding low cuts in long grass conditions. Be prepared to make two cuts when the grass is long.  
(Refer fig.11)

## Non Grassed Areas

When moving the mower across non grassed areas, stop the engine and set the mower to the maximum height of cut to protect the cutting mechanism.  
(Refer fig.11)

## Grassbag

Raise the rear deflector, lift the grassbag and lower the rear

deflector to rest against the rear of the mower.

To empty the grassbag, pour out the grass clippings and shake the grassbag vigorously to clean the airways. Good grass collection depends on good air flow through the grassbag. When collecting grass clippings it is important that the grassbag is emptied regularly to prevent blockages and engine overloading.

(Refer fig.12)

## Collection Without Grassbag

Remove the grassbag and operate the mower with the rear deflector in the closed position.

(Refer fig.13)

Fig. 10

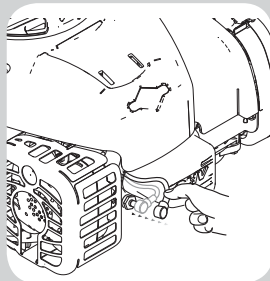

Fig. 11



Fig. 12

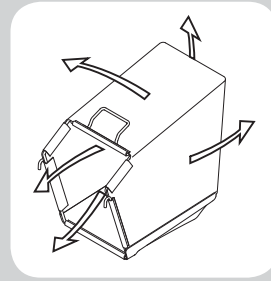
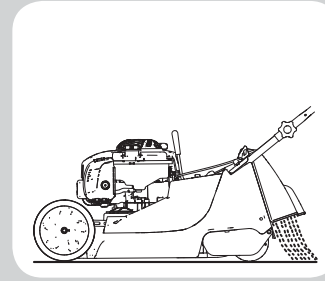

Fig. 13



# OPERATING THE MOWER

## Heavy Growth

Areas of heavy growth should be mown without collecting the clippings. If collection is required, first mow the area without the grassbag at the maximum height of cut setting.

Allow the grass clippings to dry out and then mow the area at the maximum height of cut setting with the grassbag fitted.

Reduce the height of cut and mow the area again as necessary until the required finish is obtained.

To prevent damage to your lawn do not remove more than one third of grass height in one cut.

*(Refer fig.14)*

## Friction Disc

The cutterblade is driven by the engine via a friction disc to help prevent damage occurring to the engine crankshaft and cutting mechanism when a hidden obstruction or overload is encountered.

*(Refer fig.15)*

**Always stop the engine when a hidden obstruction or excessive vibration is encountered. Disconnect the spark plug lead and examine the cutting mechanism. ALWAYS replace a damaged cutterblade. Refer to Maintenance.**

Fig. 14

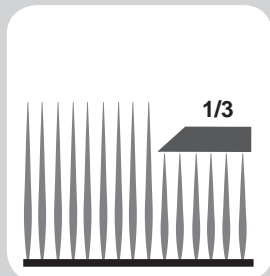

Fig. 15



# MOWER MAINTENANCE

## Engine Detail

**WARNING: Improper maintenance, use of non conforming replacement components, or the removal or modification of the engine may cause serious injury or death.**

(Refer to fig 16)

## Carburetor Adjustments

Never make adjustments to the carburetor or engine speed. The carburetor was set at the factory to operate efficiently under most conditions.

Do not tamper with the governor spring, linkages, or other parts to change the engine speed detailed in the Specification section. If any adjustments are required contact your Hayter Authorised Service Dealer for service.

## Oil Service

**WARNING: Fuel and its vapours are extremely flammable and explosive. Fire or explosion can cause severe burns or death.**

Check the oil level before every use when starting the engine and ensure that the correct oil level is maintained. Refer to Assembling the Mower Before First Use - Oil Check Level.

Change the engine oil after the first 5 hours of operation and thereafter according to the Maintenance Schedule.

1. Drain the fuel by running the engine until the fuel tank is empty.
2. Remove the spark plug lead.
3. Allow the engine to cool.
4. Remove the oil dipstick and drain the oil into a suitable container. When tipping the machine, ensure that the spark plug is kept uppermost.

(Refer to fig.17)

- Refill with new oil of the recommended SAE viscosity grade. Refer to Assembling the Mower Before First Use.

3. To loosen debris, gently tap the filter on a hard surface. If the filter is excessively dirty, replace with a new filter.

4. Install the filter (B).

5. Close the cover (A).

(Refer to fig.18)

If very dirty, replace.

## Air Filter Service

**WARNING: Never start and run the engine with the air filter removed.**

**NOTE: Do not use pressurised air or solvents to clean the filter. Pressurised air can damage the filter and solvents will dissolve the filter.**

1. Open the cover by releasing the tabs (A).
2. Remove the filter (B).

Fig. 16

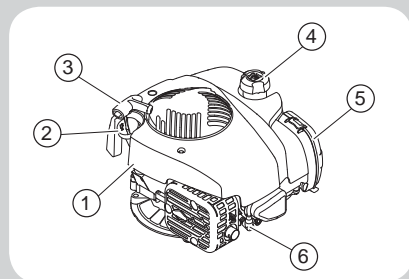

1.	Engine Cover
2.	Oil Filler & Dipstick
3.	Starter Cord
4.	Fuel Tank & Cap
5.	Air Filter
6.	Spark Plug & Lead

Fig. 17

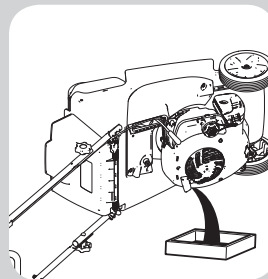
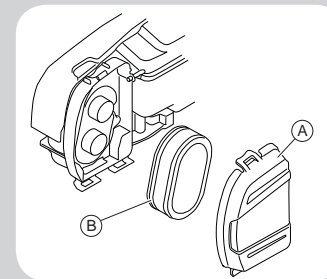

Fig. 18



# MOWER MAINTENANCE

## Spark Plug Service

**Improper maintenance, use of non conforming replacement components, or the modification of the spark plug may cause death or serious injury.**

Use only Briggs & Stratton spark tester 19368 (1) to check for a spark as shown in the diagram.

*(Refer to fig.19)*

Replace the spark plug every season. A spark plug wrench (19576) is available from any authorised Briggs & Stratton service dealer.

Check the spark plug gap (A) with a wire feeler gauge (B). If necessary, reset the gap to 0.51 mm. Install and tighten the spark plug, torque to 180 lb-in (20 Nm) .

*(Refer to fig.20)*

## Keeping Engine Clean

Remove all grass and debris from the engine including the exhaust / exhaust guard, the air ways in the top cowl and the surrounding deck areas after every use.

Never spray the engine with water during cleaning. Water can contaminate the fuel. Always clean with a brush or compressed air.

*(Refer to fig.21)*

Grass and debris may clog the engines air cooling system especially after prolonged operation whilst cutting tall, dry grass. The internal cooling fins and surfaces may require cleaning to prevent overheating and engine damage. We recommend that this service be carried out by an authorised Hayter Service Dealer.

## Grassbag

**WARNING: Improper maintenance, use of non conforming replacement components, or the removal or modification of the grassbag may cause death or serious injury.**

Remove grass debris from the grassbag immediately after use and check its condition for signs of damage.

**To prevent accidents replace a damaged grassbag immediately.**

*(Refer fig.22)*

## Easy-Wash Port

**WARNING: Improper maintenance, use of non conforming replacement components, or the removal or modification of the deck may cause death or serious injury.**

Debris build up inside a mower underdeck can impair cut and

collection performance.

Keep your mower clean by using the convenient washout port.

1. Attach a garden hose that is connected to a water supply to the washout port.

*(Refer fig.23)*

2. Turn the water on.
3. Start the engine and run it until there are no more clippings that come out from under the machine.
4. Shut off the engine.
5. Shut off the water and disconnect the garden hose from the machine.
6. Start the engine and run it for a few minutes to dry the underside of the machine.
7. Allow the engine to cool before storing the machine in an enclosed area.

Fig. 19

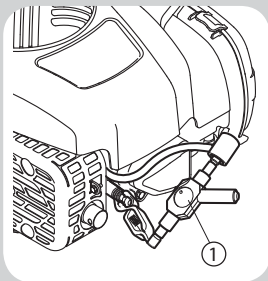

Fig. 20

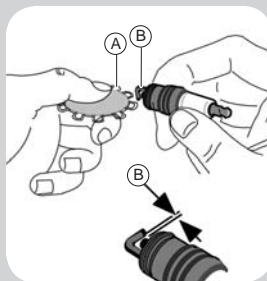

Fig. 21

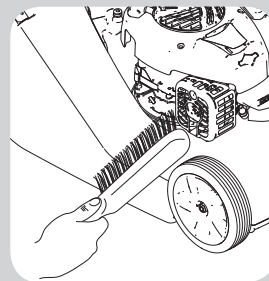

Fig. 22

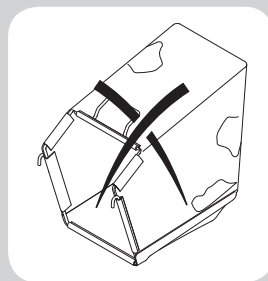
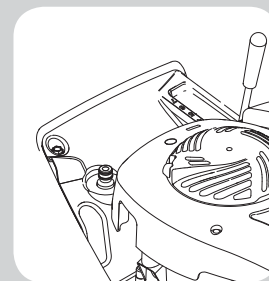

Fig. 23





# MOWER MAINTENANCE

## Securing Nuts & Bolts

Regularly check that all securing nuts and bolts are tight. Replace missing or damaged items immediately.

## Rear Deflector

**WARNING: Improper maintenance, use of non conforming replacement components, or the removal or modification of the rear deflector may cause death or serious injury.**

Remove grass debris from the rear deflector immediately after use and check its condition for signs of damage.

## Lubrication

Lubricate the wheels, pivot points and linkages with engine oil every 25 operating hours.

Apply a good quality medium grease to the inner control cables at the point of entry and exit from their outer casing.

## Cutterblade Removal

To prevent injury it is wise to seek assistance before turning the mower on its side.

Drain the fuel by running the engine until the fuel tank is empty

and the engine stops. Remove the spark plug lead and allow the engine to cool. Turn the mower on its side and ensure that the air filter side of the engine is uppermost.

**Note how the cutterblade is assembled be removing.**

Firmly grip the end of the cutterblade (1) with a gloved hand and remove bolt (1), spring washer (2) and distance piece (3) securing the cutterblade with a 9/16" A/F spanner. (Refer fig. 24)

**To prevent accidents never work on the cutterblade unless the spark plug lead has been removed. The cutterblade has sharp edges. ALWAYS wear strong work gloves to protect your hands when working on the cutterblade. DO NOT rotate tools towards the cutting edges to avoid the risk of injury should the tool slip. ALWAYS use genuine Hayter replacement parts.**

The condition of the cutterblade and its mounting arrangement should be checked regularly for signs of wear or damage. Ensure that the cutterblade is not bent or cracked.

A damaged cutterblade that is out of balance will vibrate excessively and may break. DO NOT use an unbalanced cutterblade.

Regularly check that the bolt securing the cutterblade is tightened to the specified torque of 54 Nm.

Replace the cutterblade every 2 years or sooner if excessively worn or damaged.

## Cutterblade Assembly

Assemble the cutterblade (4) with the turned up edges facing towards the engine. Secure the cutterblade (4) using the bolt (1), spring washer (2) and distance piece (3). (Refer fig. 24)

The blade will curve slightly when tightened against the friction disc.

Fig. 24

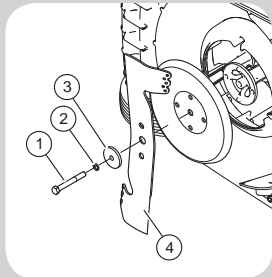

# MOWER MAINTENANCE

## Cutterblade Sharpening

A slightly worn cutterblade may be re-sharpened. Both blade edges must be sharpened equally to ensure balance. Sharpen the cutterblade every 25 mowing hours or more frequently if conditions require. Remove the cutterblade from the mower and clean using a brush and water.

Inspect the cutterblade for signs of damage.

Sharpen both cutting edges with a flat file to restore performance.

*(Refer fig.25)*

Ensure that the cutterblade is balanced. Use a screw driver with a round shaft to support the cutterblade through its centre hole. Hold the cutterblade horizontal and then release. A balanced cutterblade will remain horizontal.

*(Refer fig.26)*

If the cutterblade is not balanced the heavy end will rotate downwards. Sharpen the heavy end until the cutterblade is correctly balanced.

*(Refer fig.27)*

## Storage

When storing your mower away, ensure that cables do not become snagged at the pivot point and depress the engine stop lever to prevent it being damaged through contact with the engine.

To store the handle, unscrew the 2 small securing knobs sufficiently to allow it to be pivoted forwards to rest against the mower.

*(Refer fig.28)*

Engines stored in excess of 30 days need to be protected with fuel additive or drained of fuel to prevent gum from forming in the fuel system or on essential carburettor parts.

To ensure your mower is maintained in good working order it is important that the following procedure is adopted. Refer to the Maintenance section as necessary.

- Drain fuel from the engine by operating the engine until it stops.
- Disconnect the spark plug lead.
- Change the engine oil.
- Remove the engine spark plug and pour 15ml of engine oil into the engine cylinder and replace the spark plug. Do not exceed the stated volume of oil as engine damage may occur on re-starting. Do not replace the spark plug lead. Slowly pull the engine start-cord once to crank the engine. This will distribute the oil and help prevent engine corrosion.
- Clean grass and debris from the engine cylinder, cylinder head cooling fins, under top cowl, around and behind exhaust/exhaust guard and ensure that the grassbag is clean.
- Lubricate the mower and treat metal parts with a water repellent anti-corrosion product.
- Cover the mower with a protective sheet and store it in a

dry, ventilated area.

Fig. 25



Fig. 26

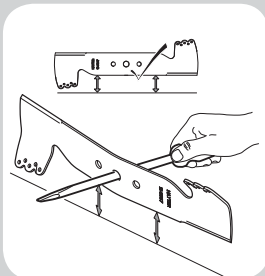

Fig. 27

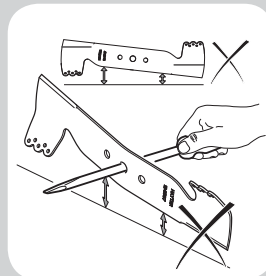
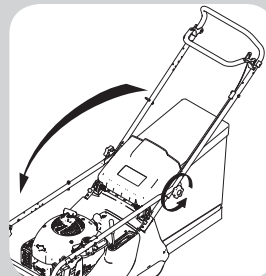

Fig. 28





# ***MAINTENANCE SCHEDULE***

Follow the hourly or calendar intervals, whichever occurs first.

More frequent service will be required if working for prolonged periods under dusty, dry conditions, when airborne debris is present or after extensive operation cutting tall, dry grass.

## ***First 5 Hours***

- After the very first five hours change the engine oil.

## ***Daily or Each Use***

- Check the oil level.
- Remove grass debris from around the engine, exhaust/exhaust guard, airways in the top cowl and the underside of the deck housing.
- Check the condition of guards and safety devices.
- Check condition of cutterblade.
- Check condition of grassbag and ensure airways are clear (replace if damaged).

## ***25 Hours Or Every Season***

- Change the engine oil if continuously operating under heavy load or high ambient temperature.
- Service the air filter.
- Lubricate wheels, pivot points and linkages.
- Grease the inner control cables at point of entry and exit from their outer casing.
- Sharpen the cutterblade.

## ***50 Hours Or Every Season***

- Change the engine oil.
- Clean the air filter.

## ***100 Hours Or Every Season***

- Clean the engine cooling system. Clean more often under dusty conditions or when airborne debris is present or after prolonged operation whilst cutting tall, dry grass.
- Replace the spark plug.
- Replace the air filter.

**Failure to follow this maintenance schedule could result in non warrantable failures.**

# *LAWN CARE CALENDAR To be used as a guide only*

## *January*

There is very little work to do this month apart from brushing away leaves. Keep off the grass if frozen or waterlogged.

## *February*

Rake the grass thoroughly. Spike the lawn to aerate and stimulate soil organisms and root growth and apply lawn sand if necessary.

## *March*

The yearly lawn work programme really starts this month. As soon as the ground conditions are suitable, the first cut can be made. The first cut should merely “top” the grass as close cutting at this stage could result in severe yellowing or browning. Two cuts are generally sufficient this month.

## *April*

Mow often enough to stop grass growing away. Dig out patches of coarse grass or resistant weed. Re-seed bare patches.

## *May*

Keep mowing increasing the frequency as required. Treat with selective weed killers or combined weed/feed preparations if you did not feed the lawn in April.

## *June*

Summer mowing should now be under way. It should be necessary to mow the lawn twice a week. Raking before mowing is important this month as the combined action keeps runners of clover under control. Water the grass if necessary, and remember to soak thoroughly.

## *July*

Treat the grass with the second application of fertiliser or weed killer/fertiliser. Water when necessary and rake occasionally. As a general rule the grass clippings should be removed each time you mow. If weather conditions are dry and hot and the grass is weed free, leave the clippings on the lawn to help maintain ground moisture.

## *August*

Keep mowing regularly and watering as necessary. Fill any cracks caused by drought with a mixture of sharp sand and soil. In dry weather conditions leave the grass longer to help retain ground moisture.

## *September*

Raise the height of cut to allow the grass to thicken and protect the roots from the winter frost and snow.

## *October*

Rake out the thatch from the turf and spike the lawn to assist in drainage. Brush in peat and sharp sand.

## *November*

Use a stiff broom to disperse worm casts before mowing. Keep turf free from leaves.

## *December*

Apart from brushing away leaves, December is a slack end of a busy year. Keep off the lawn if it is very wet or frozen.

### **Lawn Stripes**

The way to achieve a neat striped effect is for the lawn being cut in parallel stripes, alternate stripes being mown in opposite directions. A much more important routine is to cut at right angles to the line of the previous mowing. If the work has been carried in a north-south line, then the next cutting should be in an east-west direction. The cross-cutting keeps down the coarse weed grasses.

**To prevent grass damage do not remove more than one third of the grass height in one cut.**

# TROUBLE SHOOTING

PROBLEM	CAUSES	CORRECTIVE ACTION
<b>Engine will not turn over</b>	Engine stop lever released	Operate engine stop lever
	Incorrect oil level	Check oil level
	Obstruction under deck	Remove obstruction
<b>Engine smokes</b>	Excess oil	Check oil level
	Air filter cartridge oil soaked or blocked	Service air filter
<b>Engine runs then stops</b>	Fuel starvation	Fill fuel tank
	Fuel cap vent blocked	Clean fuel cap vent
<b>Engine will not start</b>	Engine under load	Raise the height of cut
	Incorrect / contaminated fuel	Drain tank and fill with correct fuel
	Spark plug lead disconnected	Connect spark plug lead
	Engine brake not released	Operate engine brake lever
	Faulty spark plug	Clean and adjust the gap or replace
	Wiring fault	Check wiring
<b>Engine runs rough</b>	Spark plug lead becoming disconnected in use	Connect spark plug lead
	Faulty spark plug	Clean and adjust gap or replace
	Air filter blocked	Service air filter
	Incorrect / contaminated fuel	Drain tank and fill with correct fuel

PROBLEM	CAUSES	CORRECTIVE ACTION
<b>Engine vibrates excessively</b>	Mounting bolt loose	Tighten bolt
	Cutterblade bolt loose	Tighten bolt
	Cutterblade out of balance	Balance cutterblade
	Bent crankshaft	Consult your dealer
<b>Uneven cut</b>	Undulating ground conditions	Change direction of travel
	Cutterblade worn	Sharpen cutterblade
	Cutterblade out of balance	Balance the cutterblade
	Wheels/roller damaged	Inspect and replace as necessary
<b>Discharge chute blocks</b>	Grass is wet	Mow dry grass
	Cut height too low	Increase cut height
	Grassbag full	Empty grassbag
	No airflow through the grassbag	Clean the grassbag
<b>Mower is hard to push</b>	Cut height too low	Increase cut height
	Wheels/roller damaged	Inspect and replace as necessary
<b>Mower will not self propel</b>	Drive belt damaged	Replace drive belt
<b>Poor grass condition</b>	No airflow through the grassbag	Clean the grassbag
	Discharge chute blocked	Remove blockage
	Wet grass	Mow dry grass
	Grassbag full	Empty grassbag
<b>Cutterblade drive will not engage/disengage</b>	Engine stop lever not fully forward	Push fully forward to disengage

# WARRANTY

## **5 Year Warranty - Residential Use 90 Day Warranty – Commercial Use**

Hayter Limited warrants to the original purchaser that this unit shall be free from defects in material and workmanship, under normal, residential use, for a period of five years from the date of purchase or, if used commercially, for a period of 90 days from the date of purchase. To qualify for the 5 year warranty, you must have the machine serviced annually by an Authorised Hayter Service Dealer\* within 12, 24, 36 and 48 months of the date of purchase. Please note that these services will be charged at a rate agreed between you and the Dealer. If the machine is not serviced annually, the warranty will automatically expire twelve months after the machine's most recent annual service.

### **Lifetime Crankshaft Warranty**

All Hayter branded machines which are fitted with a genuine Hayter Friction Disc or Crankshaft Support Bearing as original equipment, used by the original purchaser in accordance with recommended operating and maintenance procedures, are covered by a Lifetime Warranty against engine crankshaft bending. Machines fitted with friction washers, Blade Brake Clutch (BBC) units and other such devices are not covered by the Lifetime Crankshaft Warranty.

In the event of a crankshaft bending, an ASD should gain prior authorisation for repair from the Hayter Limited Service Department on 01279 723444.

The crankshaft must be obtained from the relevant engine manufacturer. Please include the supplier name, part number, description, unit cost less VAT and quantity in the 'Additional Expenditure' section of the Electronic Warranty Claim.

### **Lifetime Deck Warranty**

Hayter Limited warrants to the original purchaser that the mower deck, consisting of the die cast structure to which the engine is secured, will not crack or break during normal use for the lifetime of the product. If such damage occurs Toro shall, at our option, repair or replace the mower deck at no cost. Deck failure due to misuse or abuse and corrosion occurring due to lack of regular maintenance are not covered. Machines used commercially are excluded from this warranty.

### **Terms and Conditions**

Hayter shall, at our option, repair or replace any part covered by warranty during the applicable period.

Your product must be registered within 14 days of purchase to qualify for the full benefit of the product warranty. Please go to [www.hayter.co.uk/warranty-registration](http://www.hayter.co.uk/warranty-registration) to complete this process.

This warranty does not apply to any unit that has been tampered with, altered, misused, abused or used for hire, and will become invalid if non genuine Hayter parts are fitted. Minor mechanical adjustments are not covered unless they are due to defective material or workmanship. Consult the Owner's Handbook or a Hayter Authorised Service Dealer for assistance when making these adjustments.

### **Making a Claim**

To make a warranty claim, return the unit to a Hayter Authorised Service Dealer, along with proof of purchase stating the machine serial number and date of purchase and the service receipt(s) or stamped service card.

This warranty gives you specific legal rights and are in addition to any statutory rights to which you may be entitled. Your statutory rights are not affected by this warranty. If you need additional information concerning this written warranty, or assistance in obtaining services, please write to: HAYTER LIMITED, Service Department, Spellbrook, Bishop's Stortford, Hertfordshire CM23 4BU.

\*Details of your local Hayter Authorised Dealer can be found on the Hayter website [www.hayter.co.uk](http://www.hayter.co.uk) or contact: Freephone 0800616298.

## The Information Hayter Collects

This warranty is jointly administered by Hayter Limited (Hayter) and its affiliate, Toro Warranty Company (Toro). Hayter and Toro respect your privacy. In order to process your warranty claim and contact you in the event of a product recall, we ask you to share certain personal information with us, either directly or through your local Hayter dealer.

Your personal information will be processed by Hayter in the UK. It will also be entered into the Toro warranty system, which is hosted on servers located within the United States where privacy law may not provide the same protection as applies in your country.

BY SHARING YOUR PERSONAL INFORMATION WITH US, YOU ARE CONSENTING TO THE PROCESSING OF YOUR PERSONAL INFORMATION AS DESCRIBED IN THIS PRIVACY NOTICE.

## The Way We Use Information

Hayter and Toro may use your personal information to process warranty claims, to contact you in the event of a product recall, to gauge customer satisfaction, and for any other purpose which we tell you about. We may share your information with our parent, The Toro Company, or with our affiliates, dealers or other business partners in connection with any of these activities. We will not sell your personal information to any other company. We reserve the right to disclose personal information in order to comply with applicable laws and with requests by the appropriate authorities, to operate our systems properly or for our own protection or that of other users.

## Retention of your Personal Information

We will keep your personal information as long as we need it for the purposes for which it was originally collected or for other legitimate purposes (such as regulatory compliance), or as required by applicable law.

## Our Commitment to Security of Your Personal Information

Hayter and Toro take reasonable precautions in order to protect the security of your personal information. We also take steps to maintain the accuracy and current status of personal information.

## Access and Correction of your Personal Information

If you would like to review or correct your personal information, please contact us by email at [legal@toro.com](mailto:legal@toro.com).

June 11, 2012

*NOTES*

*NOTES*



# SERVICE RECORDS & CUSTOMER INFORMATION

Please ensure that upon completion of each chargeable Service you retain your invoice/receipt.

**1<sup>st</sup> Year (12 Months)**

We certify that this service has been carried out by an Authorised Hayter Service Dealer

Date: \_\_\_\_\_

DEALER DETAILS

**2<sup>nd</sup> Year (24 Months)**

We certify that this service has been carried out by an Authorised Hayter Service Dealer

Date: \_\_\_\_\_

DEALER DETAILS

**3<sup>rd</sup> Year (36 Months)**

We certify that this service has been carried out by an Authorised Hayter Service Dealer

Date: \_\_\_\_\_

DEALER DETAILS

**4<sup>th</sup> Year (48 Months)**

We certify that this service has been carried out by an Authorised Hayter Service Dealer

Date: \_\_\_\_\_

DEALER DETAILS

Date of Sale:- \_\_\_\_\_

Engine Type:- \_\_\_\_\_

Engine:- \_\_\_\_\_

DEALER DETAILS

SERIAL NO. LABEL

**Hayter Limited**

Spellbrook, Bishop's Stortford,  
Hertfordshire CM23 4BU England

Tel: +44 (0)1279 723444 Fax: +44 (0)1279 600338

www.hayter.co.uk